

Product information TCXO (Precision TCXO)

For consumer • Industries **XTCLH / XNCLH Series**

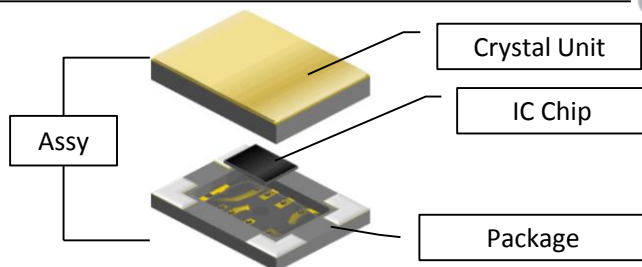

(5.0 x 3.2 x 1.5 mm)



Features

- Supports 10 MHz to 50 MHz
- Stratum 3 specification compliant
- Excellent temperature stability: ± 0.2 ppm (-40 to 85 °C)
- Excellent aging characteristic: ± 3.0 ppm / 20 yrs.

Application

- Base station, Network equipment
- GPS
- Wireless devices for business use
- Other consumer applications

Standard specification

Item	CMOS		Clipped sine wave		Condition
	VC-TCXO	TCXO	VC-TCXO	TCXO	
Series	XTCLH * C	XNCLH * C	XTCLH * T	XNCLH * T	
Frequency	10 MHz ~ 50 MHz 10, 12.8, 16.384, 19.2, 20, 24.576, 25, 26, 30.72, 38.4, 40, 49.152, 50				
Supply voltage	3.0 \pm 5 %, 3.3 \pm 5 % (Supply Voltage Range : 2.8 ~ 5.0 V)				
Operating Temperature	-40 ~ +85 °C				
Load Capacitance	15 pF		10 k Ω // 10 pF		
Frequency Tolerance	± 0.5 ppm max.				@ +25 \pm 2 °C
Frequency stability over temperature	± 0.28 ppm max.		± 0.20 ppm max.		@ -40 ~ +85 °C
Load sensitivity	± 0.10 ppm max.		± 0.05 ppm max.		Load ± 10 %
Supply voltage stability	± 0.20 ppm max.		± 0.05 ppm max.		Supply Voltage ± 5 %
Aging	± 0.5 ppm/year max.				@ +25 \pm 2 °C
	± 3.0 ppm/20years max.				
Current consumption	~ 6.0 mA max.		~ 3.4 mA max.		
Voltage Control Range	± 3.0 ppm min. ~ ± 6.0 ppm max.	-	± 3.0 ppm min ~ ± 6.0 ppm max.	-	Vc=+1.5 V \pm 1.0 V Positive
Free Run	± 4.6 ppm max. (Stratum3 grade)				

- Enable/ Disable function is selectable.
- If you have any questions or need more information , please do not hesitate to contact to us.

XTCLH/ XNCLH

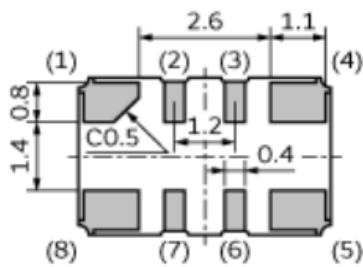
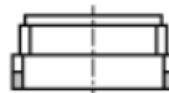
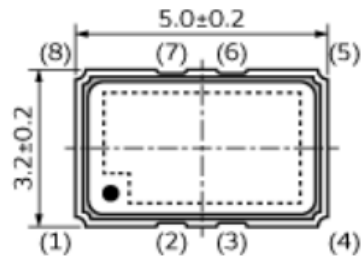

Pin Connection

- (1): Vc / GND
- (2): NC
- (3): NC
- (4): GND
- (5): Clipped Sine / CMOS OUTPUT
- (6): NC
- (7): NC
- (8): Vcc

--- Marking (in mm)