

# PV12T105A01B00

Discontinued

RoHS

REACH

## Appearance & Shape

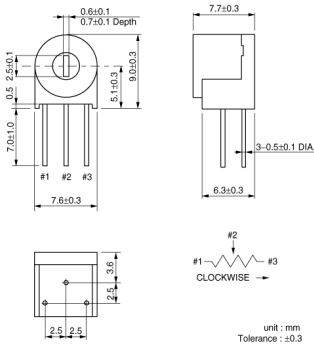

## Features

1. The unique inner gear system recognizes the position of the center of the shaft of the potentiometer.
2. Sealed construction protects the interior from dust and liquid, which achieves stable performance.
3. Available for ultrasonic cleaning after soldering.
4. Clutch mechanism prevents excessive wiper rotation.

## Packaging Information

| Packaging | Specifications | Standard Packing Quantity |
|-----------|----------------|---------------------------|
| B00       | Bulk(Bag)      | 50                        |

**Attention**  
1.This datasheet is downloaded from the website of Murata Manufacturing Co., Ltd. Therefore, it's specifications are subject to change or our products in it may be discontinued without advance notice. Please check with our sales representatives or product engineers before ordering.  
2.This datasheet has only typical specifications because there is no space for detailed specifications.  
Therefore, please review our product specifications or consult the approval sheet for product specifications before ordering.

# PV12T105A01B00



## Specifications

|  |  |
|--|--|
| Power Rating                               | 0.5W   |
| Shape                                      | Lead   |
| Maximum Working Voltage                    | 300Vdc   |
| Adjustment Direction                       | Side   |
| Size                                       | 7mm  |
| Auto Adjustment                            | No   |
| Number of Turns (Effective Rotation Angle) | 4  |
| Mechanical Rotation Angle                  | -  |
| Total Resistance Value                     | 1MΩ  |
| Total Resistance Value Tolerance           | ±10%   |
| Temperature Coefficient of Resistance      | ±100ppm/°C   |
| Resistance Taper                           | B (Linear)   |
| Contact Resistance Variation               | Less than 3% of total resistance value or 3ohm, whichever is greater |
| Residual Resistance                        | 2ohm max.  |
| Torque                                     | 14.7mN · m max.  |
| Measure Condition of RatedPower            | 70°C   |
| Operating Temperature Range                | -55°C to 125°C   |
| Mass                                       | 0.8g   |

### Attention

1.This datasheet is downloaded from the website of Murata Manufacturing Co., Ltd. Therefore, it's specifications are subject to change or our products in it may be discontinued without advance notice. Please check with our sales representatives or product engineers before ordering.

2.This datasheet has only typical specifications because there is no space for detailed specifications.

Therefore, please review our product specifications or consult the approval sheet for product specifications before ordering.

# PV12T105A01B00



## Product Data



## Constructions

### Attention

1.This datasheet is downloaded from the website of Murata Manufacturing Co., Ltd. Therefore, it's specifications are subject to change or our products in it may be discontinued without advance notice. Please check with our sales representatives or product engineers before ordering.

2.This datasheet has only typical specifications because there is no space for detailed specifications.

Therefore, please review our product specifications or consult the approval sheet for product specifications before ordering.