

MHR0422SA207K20

In Production

RoHS

REACH

Applications

Unsuitable Applications	Please be sure to read and comply with these "Precautions for use."
Specific Applications	Consumer equipment,Industrial Equipment,Medical equipment [GHTF A/B] Please refer to Our Website and specifications, etc. for information about the performance, functions, quality, management, and safety required for the above applications, and use Products after confirming the performance and reliability of the actual Product.
Recommended Applications	Copier,Printer,High-Voltage-Handling Equipment,Healthcare [Medical equipment[GHTF Class A/B]],White Goods,Air Purifier,Air Conditioner,Hair Dryer,High-Voltage Power Supply

Packaging Information

Packaging	Specifications	Standard Packing Quantity
-	Bulk(Bag)	250

Appearance & Shape

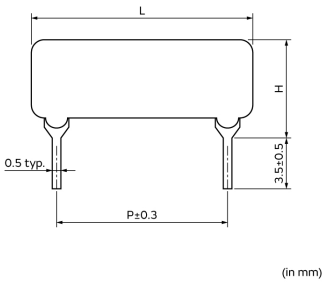

Attention
1.This datasheet is downloaded from the website of Murata Manufacturing Co., Ltd. Therefore, it's specifications are subject to change or our products in it may be discontinued without advance notice. Please check with our sales representatives or product engineers before ordering.
2.This datasheet has only typical specifications because there is no space for detailed specifications.
Therefore, please review our product specifications or consult the approval sheet for product specifications before ordering.

MHR0422SA207K20



Specifications

Power Rating	1.3W
Shape	Lead
Maximum Working Voltage	16kVdc
Resistance	200.0MΩ
Resistance Deviation	±10%
Single Use/Mold Use	Molded use
Length	22.7mm
Height H	6.5mm
Lead Pitch P	20.32mm

Attention

1.This datasheet is downloaded from the website of Murata Manufacturing Co., Ltd. Therefore, it's specifications are subject to change or our products in it may be discontinued without advance notice. Please check with our sales representatives or product engineers before ordering.

2.This datasheet has only typical specifications because there is no space for detailed specifications.

Therefore, please review our product specifications or consult the approval sheet for product specifications before ordering.