

DE21XSA680KJ3BY02F



Applications

| | |
|-------------------------|--|
| Unsuitable Applications | Please be sure to read and comply with these "Precautions for use." |
| Specific Applications | Consumer equipment, Industrial Equipment, Mobile Electronics, Medical equipment [GHTF A/B/C] except for implant equipment, Automotive infotainment/comfort equipment Please refer to Our Website and specifications, etc. for information about the performance, functions, quality, management, and safety required for the above applications, and use Products after confirming the performance and reliability of the actual Product. |

Notices

X1/Y2 Class Certified Products、 Halogen-free Products、 Rated Voltage X1:440Vac(r.m.s.)/1500Vdc Y2:400Vac(r.m.s.)/1500Vdc

References

| Packaging | Specifications | Standard Packing Quantity |
|-----------|----------------|---------------------------|
| B | Bulk(Bag) | 500 |

Appearance & Shape

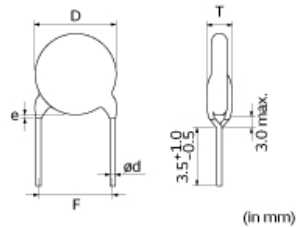

| Mass (typ.) | |
|-------------|-------|
| 1 piece | 0.28g |

Attention

1.This datasheet is downloaded from the website of Murata Manufacturing Co., Ltd. Therefore, it's specifications are subject to change or our products in it may be discontinued without advance notice. Please check with our sales representatives or product engineers before ordering.

2.This datasheet has only typical specifications because there is no space for detailed specifications.

Therefore, please review our product specifications or consult the approval sheet for product specifications before ordering.

DE21XSA680KJ3BY02F



Specifications

| | |
|--|------------------------|
| L size or Outer diameter D | 9.0mm max. |
| T size | 5.0mm max. |
| Lead spacing F | 7.5±0.8mm |
| Lead diameter d | 0.6±0.05mm |
| Paint dripping e | Up to the end of crimp |
| Capacitance | 68pF ±10% |
| Rated voltage | 400Vac(r.m.s.) |
| Temperature characteristics | SL(JIS) |
| Temperature range of temperature characteristics | 20°C to 85°C |
| Operating Temperature Range | -40°C to 125°C |
| TC | +350 to -1000ppm/°C |

Attention

1.This datasheet is downloaded from the website of Murata Manufacturing Co., Ltd. Therefore, it's specifications are subject to change or our products in it may be discontinued without advance notice. Please check with our sales representatives or product engineers before ordering.

2.This datasheet has only typical specifications because there is no space for detailed specifications.

Therefore, please review our product specifications or consult the approval sheet for product specifications before ordering.

DE21XSA680KJ3BY02F



Characteristic Data

The charts below may show another part number which shares its characteristics.

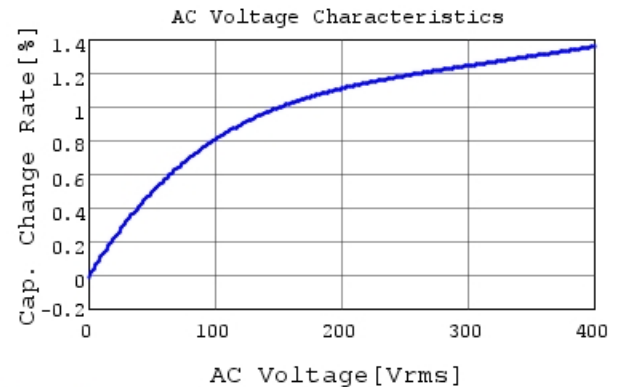
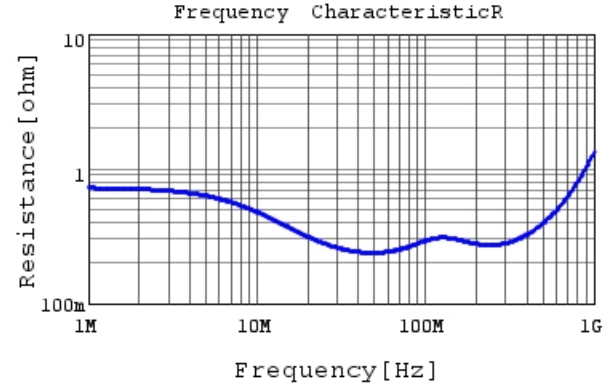
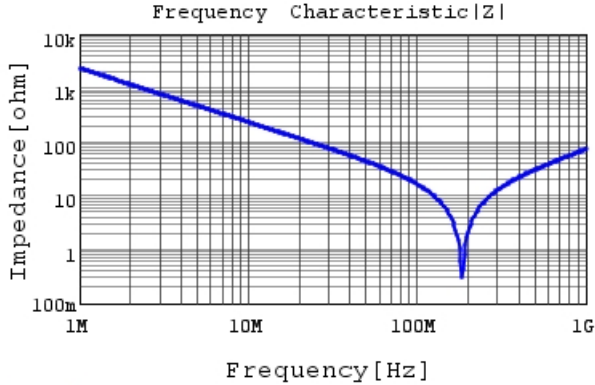

Attention

1.This datasheet is downloaded from the website of Murata Manufacturing Co., Ltd. Therefore, it's specifications are subject to change or our products in it may be discontinued without advance notice. Please check with our sales representatives or product engineers before ordering.

2.This datasheet has only typical specifications because there is no space for detailed specifications.

Therefore, please review our product specifications or consult the approval sheet for product specifications before ordering.

DE21XSA680KJ3BY02F



DE21XSA680KJ3BY02F C-Temp. capchange, DCOV,

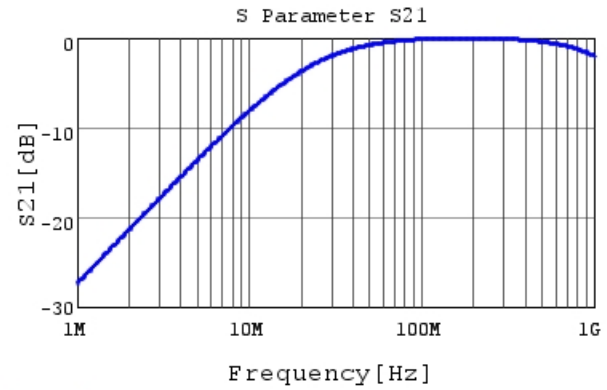

DE21XSA680KJ3BY02F S21 DCOV, 20degC

Attention

1.This datasheet is downloaded from the website of Murata Manufacturing Co., Ltd. Therefore, it's specifications are subject to change or our products in it may be discontinued without advance notice. Please check with our sales representatives or product engineers before ordering.

2.This datasheet has only typical specifications because there is no space for detailed specifications.

Therefore, please review our product specifications or consult the approval sheet for product specifications before ordering.