

# RHEL81H684K2K1H03B

In Production

AEC-Q200

RoHS

REACH

150°C max.

Low acoustic noise

Deflecting crack

Soldering crack

Flow OK

Welding

## Applications

|                         |  |
|-------------------------|--|
| Unsuitable Applications | Please be sure to read and comply with these "Precautions for use."  |
| Specific Applications   | Automotive powertrain/safety equipment, Automotive infotainment/comfort equipment, Medical equipment [GHTE A/B/C] except for implant equipment<br>Please refer to Our Website and specifications, etc. for information about the performance, functions, quality, management, and safety required for the above applications, and use Products after confirming the performance and reliability of the actual Product. |

## Notices

HF(Halogen Free)

## Appearance & Shape

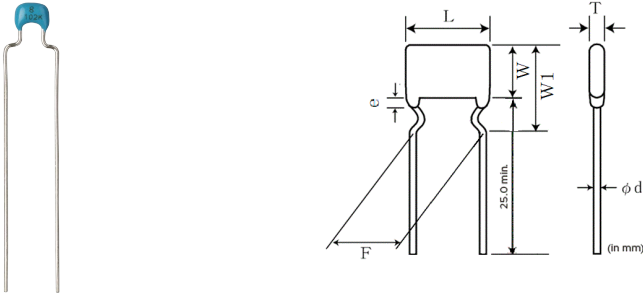

## References

| Packaging | Specifications | Standard Packing Quantity |
|-----------|----------------|---------------------------|
| B         | Bulk(Bag)      | 500                       |

| Mass (typ.) |       |
|-------------|-------|
| 1 piece     | 0.17g |

**Attention**  
1.This datasheet is downloaded from the website of Murata Manufacturing Co., Ltd. Therefore, it's specifications are subject to change or our products in it may be discontinued without advance notice. Please check with our sales representatives or product engineers before ordering.  
2.This datasheet has only typical specifications because there is no space for detailed specifications.  
Therefore, please review our product specifications or consult the approval sheet for product specifications before ordering.

# RHEL81H684K2K1H03B



## Specifications

|  |                        |
|--|------------------------|
| L size or Outer diameter D                       | 5.5mm max.             |
| Width  | 4.0mm max.             |
| T size   | 3.15mm max.            |
| Lead spacing F                                   | 5.0±0.8mm              |
| Lead diameter d                                  | 0.5±0.05mm             |
| Paint dripping e                                 | Up to the end of crimp |
| Capacitance                                      | 0.68μF ±10%            |
| Rated voltage                                    | 50Vdc                  |
| Temperature characteristics                      | X8L(MURATA)            |
| Capacitance change rate                          | +15/-40%               |
| Temperature range of temperature characteristics | -55°C to 150°C         |
| Operating Temperature Range                      | -55°C to 150°C         |
| W1 size  | 6.0mm max.             |

### Attention

1.This datasheet is downloaded from the website of Murata Manufacturing Co., Ltd. Therefore, it's specifications are subject to change or our products in it may be discontinued without advance notice. Please check with our sales representatives or product engineers before ordering.

2.This datasheet has only typical specifications because there is no space for detailed specifications.

Therefore, please review our product specifications or consult the approval sheet for product specifications before ordering.

# RHEL81H684K2K1H03B



## Characteristic Data

The charts below may show another part number which shares its characteristics.

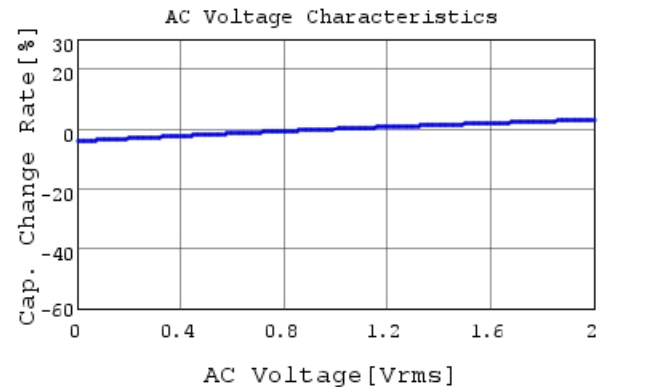
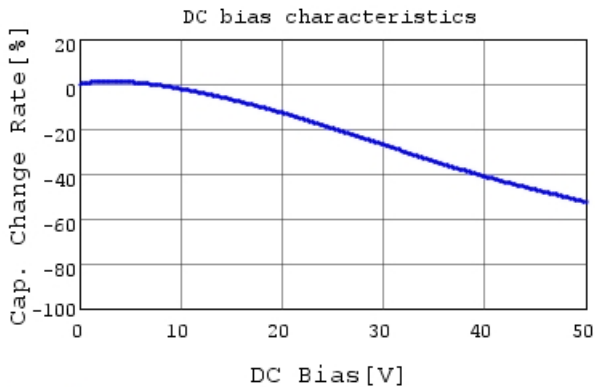
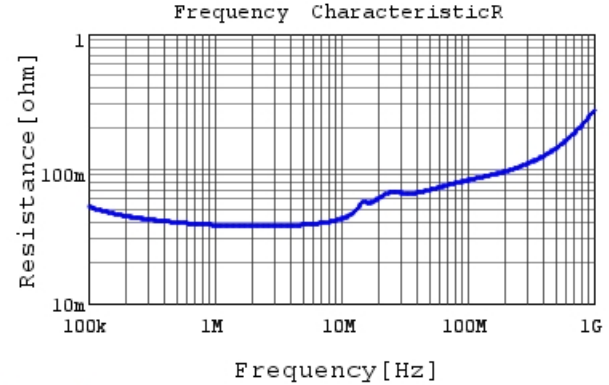
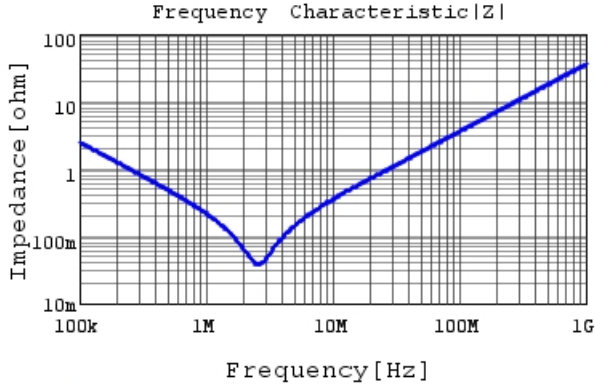

### Attention

1.This datasheet is downloaded from the website of Murata Manufacturing Co., Ltd. Therefore, it's specifications are subject to change or our products in it may be discontinued without advance notice. Please check with our sales representatives or product engineers before ordering.

2.This datasheet has only typical specifications because there is no space for detailed specifications.

Therefore, please review our product specifications or consult the approval sheet for product specifications before ordering.

# RHEL81H684K2K1H03B

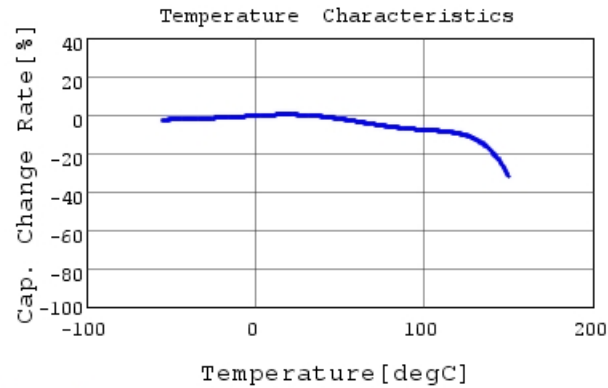

RHEL81H684K2K1H03B C-Temp. capchange, DCOV,

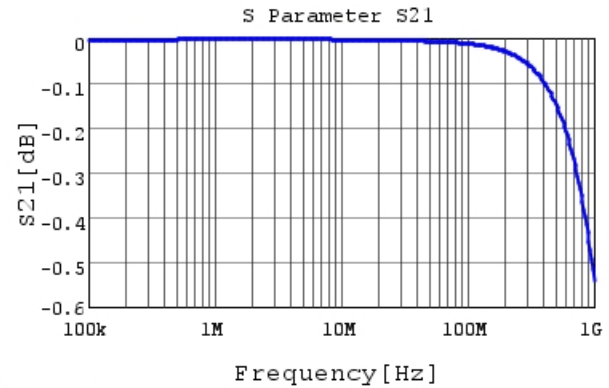

RHEL81H684K2K1H03B S21 DCOV, 25degC

**Attention**

1.This datasheet is downloaded from the website of Murata Manufacturing Co., Ltd. Therefore, it's specifications are subject to change or our products in it may be discontinued without advance notice. Please check with our sales representatives or product engineers before ordering.  
2.This datasheet has only typical specifications because there is no space for detailed specifications.  
Therefore, please review our product specifications or consult the approval sheet for product specifications before ordering.